

SANSUI

USER MANUAL

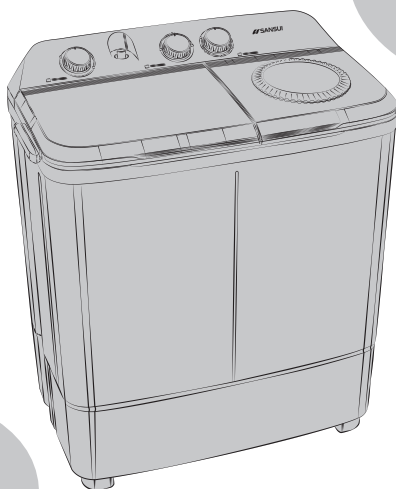

Semi-Automatic Washing Machine

Model No.: JSX65S/JSX72S/
JSX82S/JSX11S

Thank you for choosing Sansui washing machine.

Our washing machines are developed with high-technical and quality standards, with features to offer you even more comfort.

Read all instructions before using this appliance as this book contains valuable information about operation, care and service. Keep it in a safe place.

CONTENTS

The symbol you will see on some paragraphs of this booklet has the following meaning:



The warning triangle emphasize information that is particularly important for your safety or correct functioning of the appliance.

Safety Information

Safety Information	1
--------------------------	---

Structure Instruction

Name of Parts	2
Description of Control Panel	2
Preparations before using the Washing Machine	2

Installation

Installation Site	3
Connect the Drain Hose	3
Change the position of the Drain Hose	3
Fix Legs Installation Method	4
Method of Assembling Water Filter (Optional Accessory)	4

Usage Method

Notes before Washing	5
Approximate Weight Reference of Washing Materials	5
Washing Method	6
Rinsing Method	6
Spinning Method	7

Maintenance

Case Maintenance	8
Cleaning the Lint Filter	8
Antifreezing Protection	8

Others

Notes	9
-------------	---



This appliance is not intended for use by persons (including children) with reduced physical, sensory or mental capabilities, or lack of experience and knowledge, unless they have been given supervision or instruction concerning use of the appliance by a person responsible for their safety. Children should be supervised to ensure that they do not play with the appliance.

When the spin tub is running, be careful to avoid touching washing materials and the spin tub with your bare hands.

If the spin tub doesn't stop running within 15 seconds after the spin cover is opened, please stop using it and contact the designated consumer service center.



Items that cannot be washed and spinned with your bare hands.

Do not wash items that are stained with paint, petrol and other volatile or flammable substances, as this could cause a fire. In addition, such items as ropes and buttons should be packed before washing and spinning.



Do not install the washing machine in the bathroom.

This will prevent the case from corrosion and reduce the insulation performance.

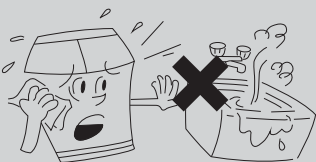

Do not forget to close the inner spin cover.

If washing materials in the spin tub are tossed out, they are easily damaged.

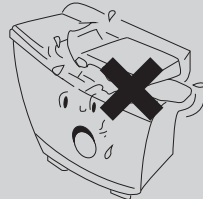

Notes for scrubbing

In order to avoid damaging electrical components, do not scrub operation parts of the control panel with water.

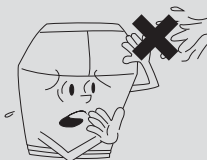

Do not use warm water above 50°C

This will prevent plastic deformation and aging.

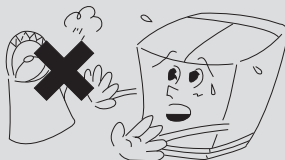

Do not let children play near the tub.

It's very dangerous if children fall into the tub.



Keep away from sources of ignition and heat.

In order to avoid deformation and fire, do not place lit mosquito coils or candles on the washing machine



Be sure to comply with all the notes above.

Name of Parts

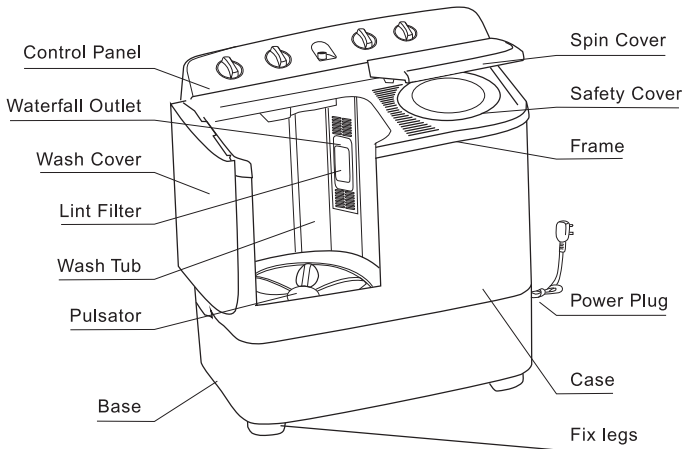

Description of Control Panel

(Artwork only to hint, the specific should follow real objects)

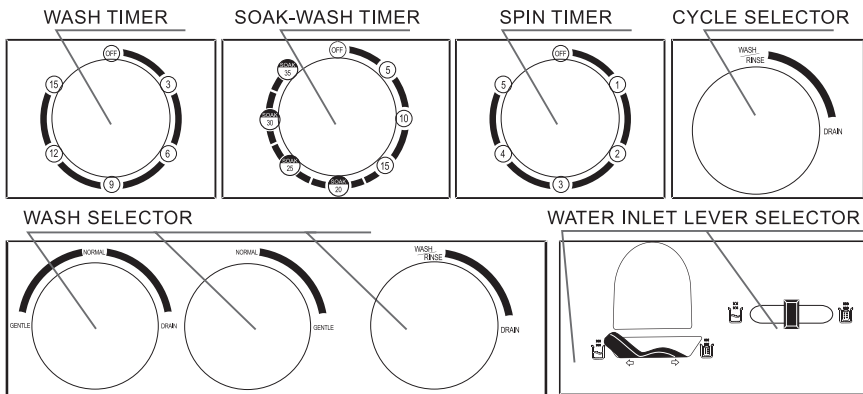

Preparations before Using the Washing Machine

- To make sure connect the inlet hose to water supply tap.
- Lay down the drain hose to the drain floor or connect it to the sewer.
- To make sure water inlet lever selector is in the left position while washing or rinsing and right position while spining.
- Refer to the reference data in the table for washing.

Installation Site

In order to avoid electrical failure, discoloration and deformation, do not install the product in the following places:

- Locations exposed to direct sunlight,
- Locations exposed to rain or high humidity,
- Uneven sloping surface and unstable ground.



Connect the Drain Hose

- Never let the end of the drain hose be immersed in water.

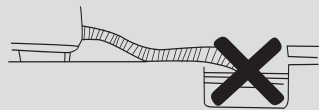

Connecting power and grounding

- The grounding plug is connected to the power plug. Do not alter it.
- The grounding plug must be secure in the power socket.

Change the position of the Drain Hose

(Artwork only to hint, the specific should follow real objects)

The ex-factory installation position of the drain hose is located on the spin side. According to the installation site, the drain hose can also be installed on the wash side of the machine. The method is as follows:

- 1 Unplug the power cord and drain the water in the hose completely.
- 2 Spread the soft material (e.g. a blanket) and place the washing machine on it gently.
- 3 Take the drain hose out from the buckle on the spin side, and put it into the buckle on the wash side.
- 4 Hang up components of the drain hose.

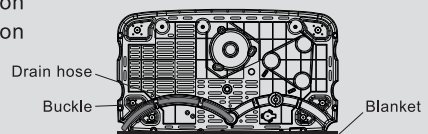
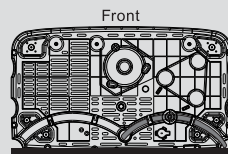

Fix legs installation method

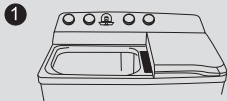

1 Take away this wash cover

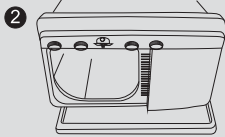

2 Lay down the machine on the soft sheet, front side on the ground.

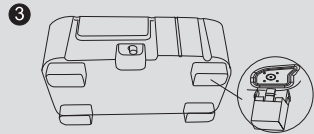

3 Install 4 feet onto the bottom of the machine.

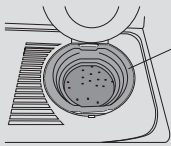

EPS

Please remove the EPS foaming part out of the spin tub, before to use the machine for the first time.

Method of Assembling Water Filter (Optional Accessory)

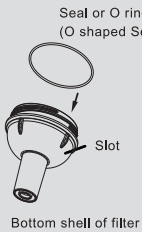

Bottom shell of filter

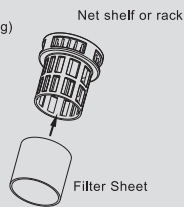

Filter Sheet

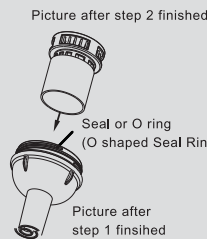

Picture after step 1 finished

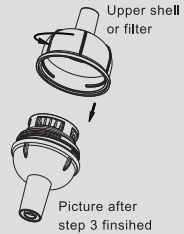

Picture after step 3 finished

1 Fix the O shaped Seal ring into the slot of filter bottom shell levelling

2 Put the filter sheet outside the shelf

3 Connect the two parts as pictures

4 Put upper shell into the parts after step 3 is finished. Then rotate the upper shell in clockwise direction as arrow showed in picture, fix it and fasten in the fastener.

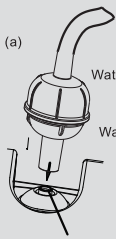

Water inlet hole on control panel

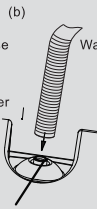

5 Connect the filter with water inlet hose and panel inlet hole.

Warnings:

1. If water leakage happens, check picture 1, first step about whether O shaped Seal ring has been fixed levelling, if not, re-fasten it again.
2. Filter Sheet is required to wash regularly. Also other component to wash is permitted.
3. This filter is not necessary for the machine. Depend on the water condition, user can decide to use filter or not.
4. Please contact consumer service to purchase this accessory.

Artwork only to hint, the specific should follow real objects

Notes before washing

- The new hose-sets supplied with the appliance are to be used and that old hose-sets should not be reused.
- Check that there are no foreign objects such as coins, hairpins, mud or sand in the pocket.
- Turn the clothes that are more likely to peel inside out.
- Strings should be knotted in advance to prevent entanglement. Fasten the zippers.
- Clothes should be classified for washing according to the texture, dirt degree and color.
- For small pieces (e.g., silk stockings) or fluffy clothes, put them into the washing net for washing.
- The maximum inlet water pressure: 0.3Mpa
The minimum inlet water pressure: 0.02Mpa

If the washing machine has a drain pump, please pay attention to the following details

- The operation of the washing machine with drain pump is the same as the one without drain pump.
- When the wash selector is turned to the drain position, the pump beings to work. It helps drain away the water.
- When the spin timer is turned, the spin tub begins rotating. The pump begins working at the same time.
- You should not hang the hook of the drain hose higher than 1.2 meters and lower than 0.8 meter or the pump may not work normally.
- Sometimes you will find that the pump is working but there is no water drained away. This is not a problem. Move the drain hose down. When there is water drained away. hang the hook of the drain hose to the height that you want.
- When draining is complete, turn off the power.

Attachment: Approximate Weight Reference of Washing Materials

<p>T-shirt (cotton) about 150 g</p>	<p>Shirt (blend) about 200 g</p>	<p>Slipover (cotton) about 500 g</p>
		
<p>Panties (cotton) about 50 g</p>	<p>Socks (blend) about 50 g</p>	<p>Scarf (cotton) about 300 g</p>
		

Washing Method

1. Insert the inlet hose into the wash inlet on the Control Panel, and turn on the tap.
2. Set the Wash Selector Knob (Normal or Gentle) according to the texture of clothes.
3. When filling water to half of the specified water level, add the detergent and stir. Put in washing materials (turn off the tap and soak for a while), and then fill water to the water level and turn off the tap.
4. Turn the Wash Timer knob to the selected time position for washing. (If the machine you purchased have the soak-wash function, please refer to the following operation: When you use the soak-wash function, you should set the soak-wash knob clockwise to the desired time position between "15" and "35", and the machine begins to soak. During the soaking, the laundry will be on intermittent flip in the washing tub. Until the end of the soaking, the machine begins to wash automatically).
5. After washing, set the Cycle Selector knob to the drain position for draining.

For the larger capacity model (capacity is greater than and equal to 8kg), this machine cannot wash beyond 4kg of blended blanket with the "hand washing" label (i.e. the blanket that can be washed by water). The method is as follows:

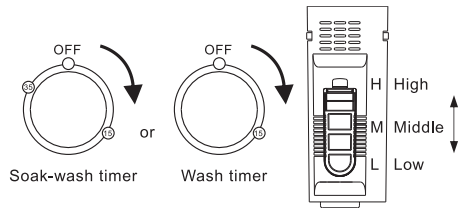

- 1 Dissolve the neutral liquid detergent with adequate water (below 50°C and pour into the washtub).
- 2 Fold the blanket as shown in the figure and put it into the tub.

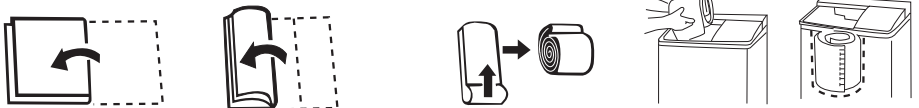

- Fold the blanket in half along the long edge
- Three folds with the same direction
- Roll up the blanket
- Put into the tub with blanket edge facing down

Rinsing Method

- 1 To save time, water and energy, please do the spinning work before rinsing. After spinning, put the clothes into the washtub.
- 2 Insert the inlet hose into the wash inlet on the control panel, and turn on the tap.
- 3 Set the Wash Selector Knob to the "Normal" or "Gentle" position according to the texture of clothes.
- 4 Select the water level based on the washing volume.
- 5 After filling water to the level, turn off the tap to save water.
- 6 Turn the wash timer knob to the selected time for rinsing.
- 7 After rinsing, put washing materials into the spin tub to spin for 1 to 3 minutes.
- 8 Drain out the rinsing water in the washtub.
- 9 According to the turbidity degree of rinsing water, materials can be rinsed several times. Spin and dry after washing.

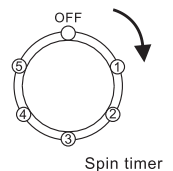

Spinning Method

1. Shake out washing materials and put them into the spin tub

2. Put the inner spin cover onto the top of cloth in the spin tub horizontally. Confirm the inner spin cover placed on is level.

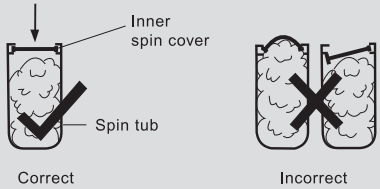
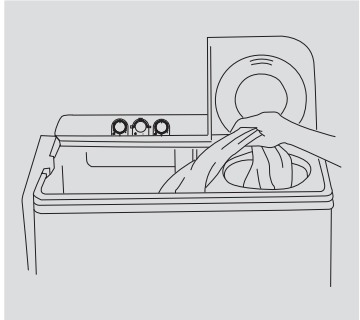

3. Cover the safety cover and spin cover.

4. Refer to the following table to select the spinning time of spin timer.

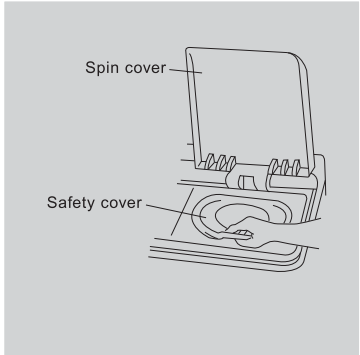

Washing materials	Spinning time
Thin clothes	About 1 minute
Knitwear (fiber)	About 1~2 minutes
Underwear (cotton)	About 2~3 minutes
Slipover (cotton/linen)	About 3~4 minutes
Toweling coverlet (cotton)	About 5 minutes

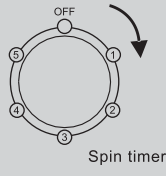

If strong vibration occurs in the spin tub, open the spin cover immediately. Make sure that the washing machine is placed on a flat, stable floor and then re-adjust washing materials by distributing them uniformly.



To do spinning and draining together, please spin for 1 minute before draining.



Do not wash or spin waterproof clothes or clothes that float easily (poncho, down and feather products etc.) in order to avoid abnormal vibration or damage to clothes.



After you use the washing machine, never forget to do the following two things:

1. Disconnect the power plug.
2. Remove the inlet hose.

CASE MAINTENANCE

After you use the washing machine, wipe the moisture and stains on its surface with a soft cloth. To avoid damage to the plastic surface, do not use cleaning agents or volatile chemicals.

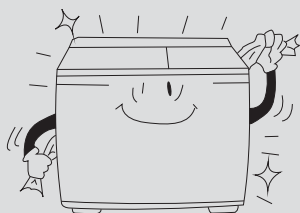

CLEANING THE LINT FILTER

▲ Removing method:

- ❶ Press the buckle and pull out the lint filter component.
- ❷ Open and empty the lint filter component and then close it again.

- ▲ Re-installation method:
After cleaning, insert the projecting parts on the lower lint filter component into the waterfall outlet and push up the buckle.

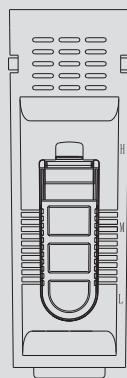

ANTIFREEZING PROTECTION

▲ To prevent from freezing:

- ❶ Turn off the tap, remove the inlet hose and drain the water completely.
- ❷ Put down the drain hose and set the drain selector knob to the "Drain" position to empty the water in the tub.

▲ If the water is frozen, please take the following steps:

- ❶ Put the inlet hose into warm water with a temperature of 50°C.
- ❷ Take about 2 liters of warm water below 50°C and put into the washtub for about 10 minutes.
- ❸ Fit the inlet hose and turn on the tap to confirm inlet and drain hoses work properly.

below 50



below 50



NOTES

The connection mode of the power cord of this machine is Y-shaped connection. The user should not open or reconnect the wire connector in the washing machine, as it will lead to adverse consequences. If this part needs to be repaired, please contact the designated consumer service center.

Note:

- After using, be sure to unplug the power cord.
- Be sure to use plug that is properly grounded.
- The maximum gradient of the supporting

surface of the washing machine should not exceed 2.

- Do not detach electrical wires and components in the machine by yourself.
- While using the machine, the vent on the base should not be blocked by foreign objects (carpets, etc.).
- Never connect the grounding wire with the live wire, or it could lead to an electric shock hazard.
- If the power cord is damaged, it must be replaced by designated engineer or consumer service center in order to avoid any hazard.

If the following symptoms occur, please disconnect the power plug and perform the following checks:

Symptom	Reason
The washing machine does not work.	<ul style="list-style-type: none"> • Check that the power supply is in good operation. • Check that the power plug is inserted properly. • Check that the wash timer knob or the spin timer knob is in the "OFF" position.
The drain hose does not work.	<ul style="list-style-type: none"> • Check that the drain hose is put down. • Check that the drain hose is not frozen. • Check that the drain hose is not blocked by lint or debris.
There is abnormal noise during washing.	<ul style="list-style-type: none"> • Check that there are no coins or any other foreign objects dropped into the washtub.
There is abnormal noise and violent vibration during spinning.	<ul style="list-style-type: none"> • Check that the washing machine is placed on a flat, stable floor. • Check that clothes are evenly distributed in the spin tub. • Check that there are no washing materials or foaming debris dropped into the outside of the spin tub.

REACH US AT

Jaina India Pvt Limited, D-170, Okhla Industrial Area, Phase-I, New Delhi-110020

Customer Care: 1860 500 3555 | Website: www.sansuiworld.com