

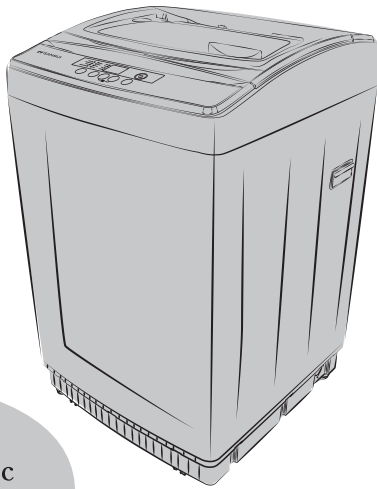

## USER MANUAL



### Fully Automatic Washing Machine

Model No.: **JSX70FTL/JSX80FTL**

Thank you for buying our product.

Please make sure to read the **Operation Manual** before operating the product to ensure safe use. Also, keep the manual handy for reference.

The symbols you will see on some paragraphs of this booklet have the following meaning:



The warning triangle and/or the key words (Warning!, Caution!) emphasize information that is particularly important for your safety or correct functioning of the appliance.



The information marked with this symbol provides additional instructions and practical tips on the use of the appliance.



Tips and information about economical and ecological use of the machine are marked with this symbol.

## CONTENTS

---

Safety information .....	1
Product description .....	3
Control panel .....	4
Use .....	5
Care and cleaning .....	7
Helpful hints in dealing with washing problems .....	9
Troubleshooting .....	10
The normal non-fault problems .....	11
Installation instructions .....	12
Environment concerns .....	15
Specifications .....	16



In the interest of your safety and to ensure the correct use, before installing and first using the appliance, read this user manual carefully, including its hints and warnings.

To avoid unnecessary mistakes and accidents, it is important to ensure that all people using the appliance are thoroughly familiar with its operation and safety features.

Save these instructions and make sure that they remain with the appliance if it is moved or sold, so that everyone using it through its life will be properly informed on appliance use and safety.

## General Safety

- It is dangerous to alter the specifications or attempt to modify this product in anyway.
- Make sure that small pets, child do not climb into the washbowl. To avoid this, please check into the washbowl before using the appliance.
- Any objects such as coins, safety pins, nails, screws, stones or any other hard, sharp material can cause extensive damage and must not be placed into the machine.
- Damage to the fabric can ensue if you overfill. Refer to the manufacturer's recommendations of quantities.
- This appliance is not intended for use by persons (including children) with reduced physical, sensory or mental capabilities, or lack of experience and knowledge, unless they have been given supervision or instruction concerning use of the appliance by a person responsible for their safety. Children should be supervised to ensure that they do not play with the appliance.
- Wash small items such as socks, laces, washable belts etc. in a washing bag or pillow case as it is possible for such items to slip down between the tub and the Pulsator.
- Do not use your washing machine to wash articles with whale bones, material without hems or torn material.
- Always unplug the appliance and turn off the water supply after use, cleaning and maintenance.
- Under no circumstances should you attempt to repair the machine yourself. Repairs carried out by inexperienced persons may cause injury or serious malfunctioning. Contact designated Service Centre. Always insist on genuine spare part.
- The new hose-sets supplied with the appliance are to be used and that old hose-sets should not be reused.
- If the power cord is damaged, it must be replaced by designated engineer or consumer service center.

## Installation

- This appliance is heavy. Care should be taken when moving it.
- When unpacking the appliance, check that it is not damaged. If in doubt, do not use it and contact the Service Centre.
- After having installed the appliance check that it is not standing on the inlet and drain hose.
- Appliance is prohibited to be placed on a carpeted floor.
- Always be sure, that there is no water leakage from hoses and their connections after the installation.
- Any plumbing work required to install this appliance should be carried out by a qualified plumber.
- Any electrical work required to install this appliance should be carried out by a qualified electrician.

## Use

- This appliance is designed for domestic use. It must not be used for purposes other than those for which it was designed.
- Only wash fabrics which are designed to be machine washed. Follow the instructions on each garment label.
- Before washing, ensure that all pockets are empty and buttons and zips are fastened. Avoid washing frayed or torn articles and treat stains such as paint, ink, rust, and grass before washing.
- Do not overload the appliance. See the relevant section in the user manual.
- Underwired bras must NOT be machine washed.
- Garments which have been in contact with volatile petroleum products should not be machine washed. If volatile cleaning fluids are used, care should be taken to ensure that the fluid is removed from the garment before placing in the machine.
- Never pull the power supply cable to remove the plug from the socket; always take hold of the plug itself.
- Never use the washing machine if the power supply cable, the control panel, the working surface or the base are damaged so that the inside of the washing machine is accessible.
- If the spin tub does not come to a stop within 15 seconds after the lid is opened, please stop using it and contact the service persons immediately for help.

## Child Safety

- This washing machine is not intended for use by young children or infirm persons without supervision.
- Young children should be supervised to ensure that they do not play with the appliance.
- The packaging components (e.g. plastic film, polystyrene) can be dangerous to children-danger of suffocation! Keep them out of children's reach
- Keep all detergents in a safe place out of children's reach.
- Make sure that children or pets do not climb into the washbowl.

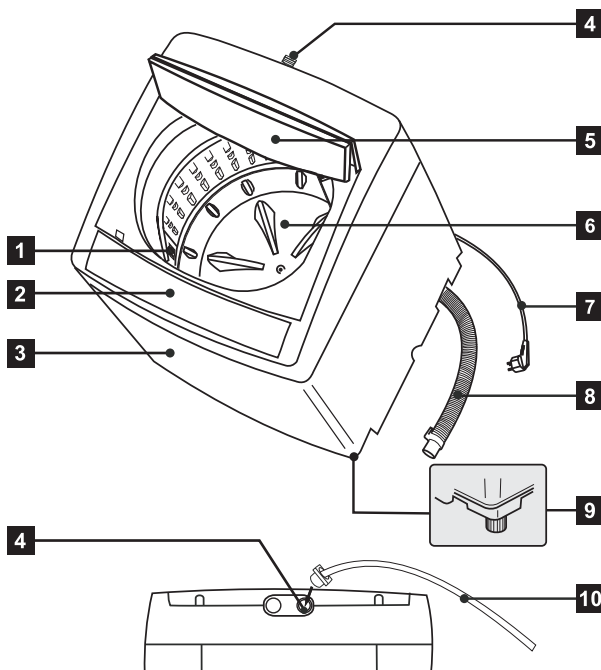

- |                            |                                |
|----------------------------|--------------------------------|
| <b>1</b> Lint Filter       | <b>6</b> Pulsator              |
| <b>2</b> Control Panel     | <b>7</b> Main cable with plug  |
| <b>3</b> Cabinet           | <b>8</b> Drain Hose            |
| <b>4</b> Water Inlet Valve | <b>9</b> Level Adjustment Feet |
| <b>5</b> Lid               | <b>10</b> Water Inlet Hose     |

## Auto Water Level

Optimised water level is automatically selected after the appliance detects the load size. This function is only available in the "Regular" program.

## Power Failure Recovery

This washing machine has last status memory and whenever power supply recovers, machine will continue with the last status before power supply was cut-off.

## Child Lock

To prevent disruption to your washing program as well as safety purpose, no respond to any changes once "Child Lock (Safety Lock)" is activated and operation will stop when the lid is opened. If lid is opened for more than 10sec, water will be discharged automatically.

Please use the washer functions according to the functions stucked on the Control Panel.

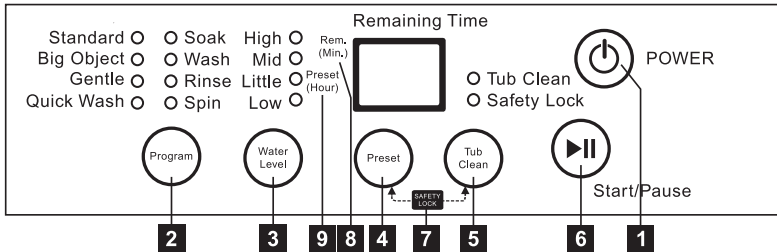

## 1 Power On/Off

After the machine is switched ON and no selection is made within 5 minutes, machine will automatically power OFF.

## 2 Program

This button is used for Program selection. Default is program Standard with the following program Sequence,

Standard→Standard+Soak→Big Object→Big Object + Soak→Gentle→Quick Wash→Wash→Rinse+Spin→Spin

**STANDARD:** Original programmer, Indicator lights on during washing, rinsing and spinning.

**BIG OBJECT:** For big, thick and dirty laundry.

**GENTLE:** For Silk clothes or undergarments.

**QUICK WASH:** For small quantity of laundry.

**SOAK:** Soaking is an additional function to the program. When soaking, the digital screen will display JP, accompanied by the rotating of pulsator. Soaking time is automatically set by volume of water selected instead of manually. Soak for 20mins for little/low water level, 30mins for mid/high water level.

**Wash:** The wash program.

**Rinse:** The rinse program.

**Spin:** Spin is needed when laundry is still wet after wash.

## 3 Water Level

This button allows you manually select your required water level if the automatic selected level in "Standard" program is not your preferred choice. You can also adjust the water level for "Gentle" and "Quick Wash" which are preset.

## 4 Preset

This button allows you to Preset the start of the washing cycle from 1hr up to 24hr.

## 5 Tub Clean

This button is used for selecting Tub Clean program for hygiene cleaning of inner & outer Tub. Use this program without clothes condition only.

## 6 Start/Pause

This button is used to start or pause the washing cycle.

## 7 Safety Lock

Press "Preset" and "Tub Clean" button together during machine operation to turn on/off the Safety Lock option. The Safety Lock option is indicated by the LED light.

## 8 Time Remaining

Time shown under this icon represent the remaining time required by the machine to finish the washing cycle.

## 9 Preset Time

Time shown under this icon represent the remaining time before the machine starts the washing cycle. When choosing "Standard", "Big object", "Gentle", "Quick Wash" or "Wash" program.

## Digital screen explanation:

Fuzzy control begins by displaying "--" on the screen. When program is working, remaining time "min" will be displayed. During preset process, preset time "hour" will be displayed. During soaking process, "JP" will be displayed.

Follow the instructions in this section for best washing results.

## Sort Your Washing Into Separate Wash Loads



Each load of washing should contain clothing which needs the same washing conditions. For example, you should not wash delicate clothes with very dirty work clothes.

Colour fast and non-colour fast fabrics should be separated. Knowing the type of fabrics you have and how dirty they are will help when you make selections from the wash program options.

Some fabrics are lint collectors and can pick up lint, dirt and colour from other fabrics which are lint producers. Some examples are listed below :

### Lint collectors

- Corduroy
- Synthetics
- Permanent press fabrics

### Lint producers

- Towels
- Nappies
- Chenille/  
Candlewick



**Make sure that you wash lint collectors separately from lint producers.**

## Check your clothes to avoid damage

Empty all pockets. Close all hooks and zippers to avoid snagging clothes.

Wash bras, pantyhose and other delicates in a mesh laundry bag, which you can purchase from your supermarket.

## Pre-treatment sprays and stain removers



**Pre-treatment sprays and stain remover can damage plastic components on your washing machine.**

If you use pre-treatment sprays or stain removers, apply them to the clothing well away from your washing machine.

## Load the washing machine

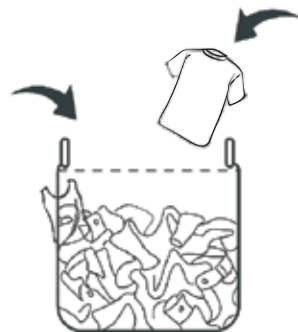

When loading the clothes into your washing machine, there are four things to remember.

- Clothes must be loaded evenly in the tub.
- Clothes must not be wrapped around in the tub.
- The washing machine must not be overloaded. Clothes must be able to move around during washing.
- A mixed load of large and small items will wash cleaner than a load of all large items, for example, sheets. The rest of the load should be small items.

## Detergent

- Don't use the wrong type of detergent. You must use a low sudsing detergent designed for washing machines. Good quality, front load detergent will perform well in this machine. Don't use soap-based products in your washing machine.
- Don't use too much detergent. This will give you too many suds causing low spin speeds, poor rinsing and overloading the motor during spin stages of the wash program.

## Adding the detergent

When using the washing machine for the first time, check that the dispenser is set for the type of detergent you will use. To do this, proceed as follows:

1. Pull out the dispenser drawer.
2. Put proper detergent into it.
3. Pull back the dispenser drawer.



Please add the detergent according to the product instruction. Please add the detergent properly if you have changed the detergent.

**Attention:** There are holes in the dispenser drawer, whose usage is letting detergent inflow into the wash bowl easier.

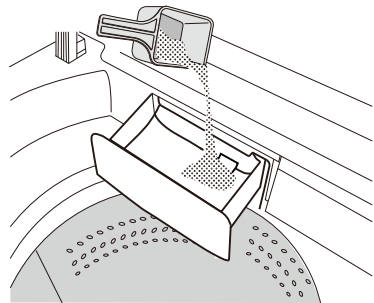

When using liquid detergent, some may leak out of the dispenser into the wash load earlier than expected through small openings in the back of the dispenser. These openings are to help the flushing out of detergent.

Close the drawer by pushing it backwards into the top panel of the washing machine when you have finished adding detergent.



## What To Do After You Have Finished Your Washing

- After washing course finished washing, the water tap must be turned off. (If required, the water inlet hose can be removed.)
- After using the washing machine, please discharge the water within the barrel out quickly in order to keep it dry without residual water.
- Plug out the power socket.
- Hang up power line and drain hose.
- Wipe up the droplet and dirt in washing machine barrel with clean soft cloth.
- Leave the lid open for a while. This allows time for moisture inside the washing machine to evaporate and for any odours to disperse.



You must DISCONNECT the appliance from the electricity supply, before you can carry out any cleaning for maintenance work.

## Cleaning Your Washing Machine

To clean the inside and outside of your washing machine you should:

- Wipe the surface with a mild dishwashing detergent and warm water.
- Wipe dry with a soft cloth.



Avoid the using of chemical medicine such as detergent and propellant, which will damage the surface.

## Cleaning Stains In The Washbowl

Stains and residue in the washbowl can be caused by:

- Metal objects such as bobby pins, dress making pins and nails.
- Salt.
- Body oils and grease from very dirty or sweaty clothes being deposited around the top of the washbowl.
- Excessive foam during wash if incorrect or too much detergent is used.



- Check all pockets before loading clothes into your washing machine.
- Don't leave wet clothing (especially swimwear) in the bowl for too long before you wash it.

### How to clean the washbowl:

- Wipe with a cleaning product which is suitable for stainless steel.
- Oily deposits can be removed by wiping surfaces with a mild dishwashing detergent and warm water.



**Never use bleach cleaners or steel wool to clean the stainless steel washbowl.**

### Cleaning of Lint Filter

Following is the concrete operation methods:

- 1: Press on the button and pull out the filter screen.

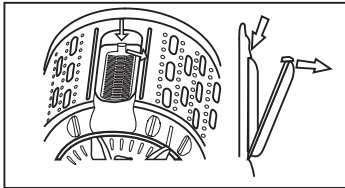

- 2: Clean the residue in the lint filter and side plate.

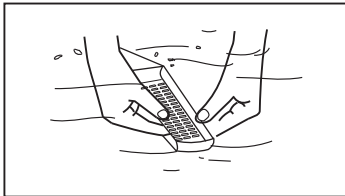

- 3: Push down the filter screen and insert it into the groove, ensure that it has been installed in place without looseness.

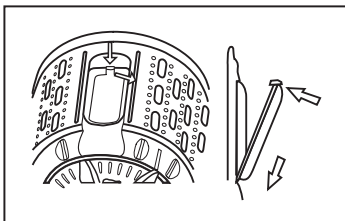

### Cleaning The Dispenser

The dispenser needs to be cleaned regularly, preferably after each wash. Inspect the dispenser after each wash to see if there is any residue of detergent. To do this proceed as follows:

- Pull the dispenser drawer forward until it stops.
- Lift the front of the drawer up and forward to remove it from the runners.
- Clean the dispenser drawer with warm water and a brush, eg, an old toothbrush.
- Dry the drawer.
- Before replacing the dispenser back in its recess, clean the inside of the recess with a brush.

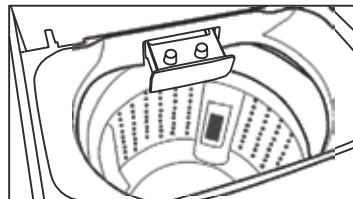

- Put the dispenser back into its runners and close the drawer.

### Cleaning Water Inlet

- The filter of water inlet valve is not allowed to be disassembled when used
- The filter of water inlet valve should be cleaned frequently.

**Residues On Washed Items**

If you are experiencing residue on some clothes, the following tips will help:

- Pre-mix the detergent thoroughly in warm water to improve the dissolving.
- Reduce detergent dosage to between a ½ and 2/3 of the manufacturer's standard recommendation to avoid over concentration. (the lower water usage requires lower detergent usage)
- Some residue may be re-deposited lint, so be careful to not have lint producing items in a load which has darker clothes.



**Some detergents have ingredients which do not fully dissolve and as a consequence, may leave white residue or particles evident on the surface of darker clothes in the finished wash load.**

**Similarly, some soils may not dissolve fully, resulting in residue evident on lighter coloured clothes.**

**Stained Clothes**

Treat all stains as soon as possible. The longer you leave a stain the harder it will be to remove. Try soakers and stain removers first.

If you use pre-treatment sprays or stain removers, apply them to the clothes in a well ventilated area away from your washing machine.

- Use light strokes and don't rub the stain remover into the fabric.
- If you use a chlorine bleach, follow the instructions on the bottle and dilute it before putting it on clothing.
- Test coloured fabrics on an inside seam for colour fastness before using any stain removers or bleaches.
- Test synthetic fabric on an inside seam before using any chemicals or bleaches.

**NOTE:** Chemicals referred to for stain removal are available from your local supermarket, hardware store or the chemist.



**Pre-treatment sprays and stain removers can damage plastic components on your washing machine.**

**Do not use dry cleaning fluids or solvents near your washing machine. These fluids will damage your washing machine and may cause an explosion.**

The maximum inlet water pressure: 0.6Mpa  
 The minimum inlet water pressure: 0.03Mpa  
 Protection Level Against Moisture IPX4  
 The wash and spin capacity refers to the maximum capacity (weight) of the standard cloth in the drying condition.

When the washing machine displays the below content with a buzzer, it will automatically power off after 10 minutes.

Identify the problem and if possible, rectify it before contacting designated service center. Do not dismantle and repair the machine without authorization.

Program	Display	Possible causes	What to do
No filling of water	<b>E1</b>	<ol style="list-style-type: none"> <li>1. Water tap is not turned on.</li> <li>2. Inlet hose is blocked.</li> </ol>	<ol style="list-style-type: none"> <li>1. Turn on the water tap.</li> <li>2. Clean tap filter/water inlet filter and press Start/Pause to resume operation.</li> </ol>
Abnormal water level signal	<b>E2</b>	<ol style="list-style-type: none"> <li>1. Water inflows too much and exceeds max water level.</li> <li>2. The water level is abnormal.</li> </ol>	The program adjusts and recovers automatically.
Machine does not operate during delay or spin dry after washing	<b>E3</b>	<ol style="list-style-type: none"> <li>1. Lid is opened when delay start is selected.</li> <li>2. Lid is opened during spin cycle.</li> </ol>	Close the lid.
Water can not be drained	<b>E5</b>	<ol style="list-style-type: none"> <li>1. Drain hose is placed too high.</li> <li>2. Drain hose is blocked /bent/squashed.</li> </ol>	<ol style="list-style-type: none"> <li>1. Lower the drain hose and press Start/Pause.</li> <li>2. Check drain hose for blockage or being bented/squashed and press Start/Pause to resume operation.</li> </ol>
Machine not working	<b>E7</b>	Lid is not closed with "Safety Lock" option selected.	Close the lid within 10 seconds and machine recovers automatically. Note: If the lid is not closed in 10 seconds, machine will drain water automatically.
Machine goes out of balance or vibrates excessively during spinning	<b>E4</b>	<ol style="list-style-type: none"> <li>1. Uneven floor.</li> <li>2. Adjustable feet is not adjusted</li> <li>3. Clothes are not evenly adjusted.</li> </ol>	<ol style="list-style-type: none"> <li>1. Adjust the machine legs to horizontal. Open the lid, and then close it, then the alarming will be cancelled.</li> <li>2. Redistribute clothes evenly.</li> </ol>

Note: In "E4" after machine had self performed load adjustment twice and unsuccessfully.

<b>PROBLEMS</b>	<b>POSSIBLE REASONS AND RELEVANT SOLUTION</b>
Machine pauses during washing or rinsing.	Machine is detecting water level which is normal operation.
Water flowing in during washing or rinsing.	The machine detects water level lower than required and automatically top up water.
Machine pause after water is fully drained.	Spin cycle is delayed to ensure complete water drain which is normal operation.
Spinning of the drum is intermittent during the initial spin cycle.	The machine program is designed with initial intermittent spinning which is normal operation.
Machine adds water into the drum during spinning cycle.	The washing load is unevenly distributed and machine is redistributing the load.
The control panel feels warm.	This is normal as some electrical components generate heat.
The machine does not continue after power supply recovers from sudden supply cut-off.	There has been continuous power supply cut-off and machine goes into power off for protection purpose.
Machine does not respond when buttons are pressed.	Child Lock option is activated. Unlock Child Lock to resume normal operation of the control buttons.
Some detergent residue in the detergent drawer.	Check the water supply pressure. The suitable water supply pressure is 0.03-0.6Mpa.

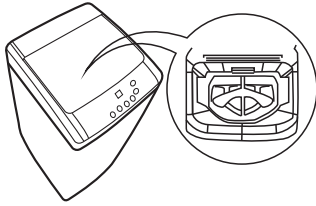

## IMPORTANT:

The top polystyrene must be removed as the last process, protecting the drum from hitting the cabinet when the machine is tilted.

## 1. Packaging base removal

After lifting the machine out, all the packaging base must be removed.,

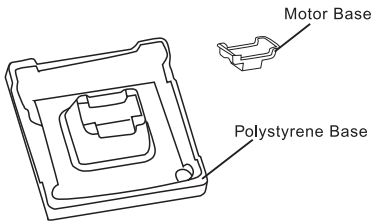

## 2. Bottom cover insertion

Lay down the machine on its back side, and insert the bottom cover into slot until to the end, then fasten the screw.

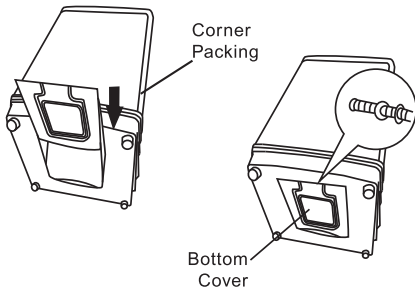

## IMPORTANT:

Prevent damage to the cabinet by placing two of the corner packing pieces supporting between back or front of machine and floor.

## IMPORTANT:

Top polystyrene must be removed after installation of bottom cover. Lift up the machine and remove the top polystyrene.

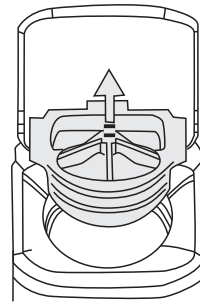

## 3. Drain hose

3.1 Hold the hose clamp and squeeze it, then put it into the drain hose for inserting.

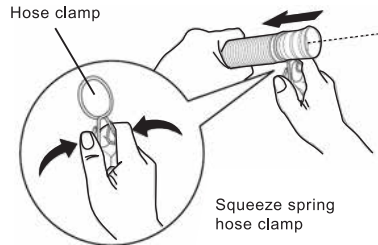

3.2 Insert drain hose into the drainage holes at the bottom of washing machine until it comes to end, then squeeze hose clamp again and shift it to the location as shown on picture to lock the drain hose.

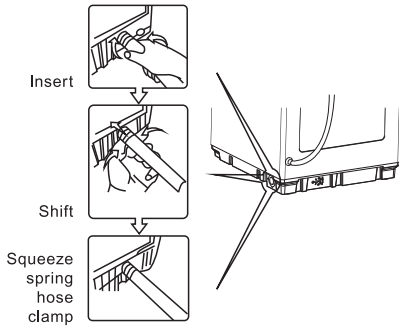

3.3 Position drain hose by adjusting the free length of hose to suit your installation.

### IMPORTANT:

Do not put hose tip into the water.  
To prevent Siphon effect.

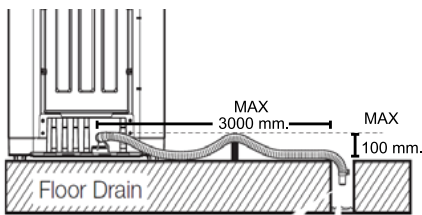

## 4. Inlet hose

### At the water tap faucet

4.1 Press the lower end of the lock lever and push down the slider. Take off the water inlet hose jointer from the water inlet hose component.

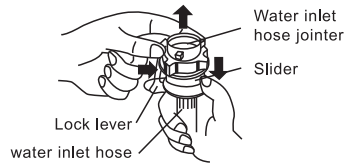

4.2 Loosen the screw till the water faucet can be accessed, Put the jointer of the water inlet hose on the faucet.

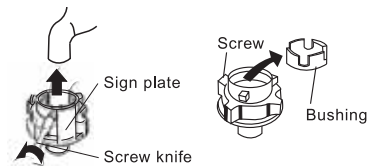

4.3 Fasten the four screws evenly, Press the lower end of the lock lever and push down the slider, put in the water inlet hose jointer to the water inlet hose component.

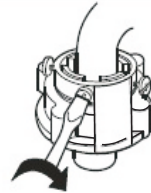

### At the washing machine

4.4 Fix the lock nut on the water inlet valve by even strength, Do not twist water inlet hose to avoid breakage.

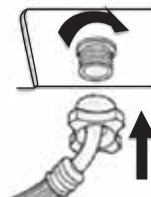

## 5. Leveling of the machine

Machine should be placed even on the floor, If the flooring is not even, adjust the adjustable feet of the washing machine until the entire machine is stable. If washer can not be adjusted evenly because of the ground, user can use some articles like plate to make machine even.

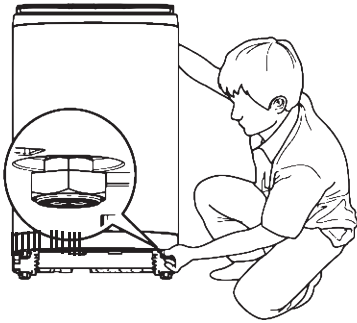

### Important:

Adjustable feet are assembled on the left or right side depending on the different models.

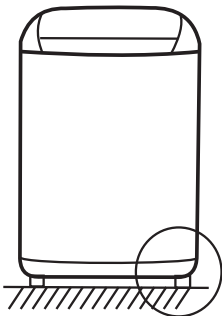

The right/left  
Adjustable  
feet

## 6. Lid and machine clearance

Machine must be placed at least 5cm free space clearance around itself.

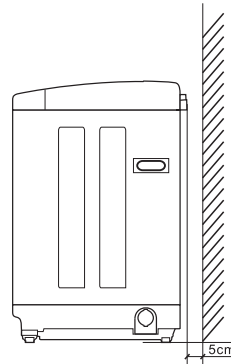

## 7. Control panel protective film

Protective film on the control panel can be removed by yourself.

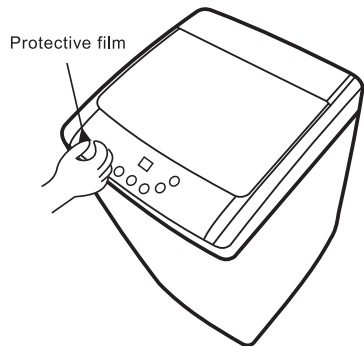



## Packaging materials



The materials marked with the symbol are recyclable.

>PE<=polyethylene

>PS<=polystyrene

>PP<=polypropylene

This means that they can be recycled by disposing of them properly in appropriate collection containers.

## Old machine

Use authorised disposal sites for your old appliance. Help to keep your country tidy!



The symbol  on the product or on its packaging indicates that this product may not be treated as household waste. Instead it shall be handed over to the applicable collection point for the recycling of electrical and electronic equipment.

By ensuring this product is disposed of correctly, you will help prevent potential negative consequences for the environment and human health, which could otherwise be caused by inappropriate waste handling of this product.

For more detailed information about recycling of this product, please contact your local city office, your household waste disposal service or the shop where you purchased the product.

## Ecological hints

To save water, energy and to help protect the environment, we recommend that you follow these tips:

- Normally soiled laundry may be washed without prewashing in order to save detergent, water and time. (The environment is protected too!)
- With adequate pre-treatment, stains and limited soiling can be removed; the laundry can then be washed at a lower temperature.
- Measure out detergent according to the water hardness, the degree of soiling and the quantity of laundry being washed.

	<b>JSK70FTL-2020S</b>	<b>JSK70FTL-2022S/C</b>	<b>JSK80FTL-2022S/C</b>
Rated voltage	220-240V	220-240V	220-240V
Rated frequency	50 Hz	50 Hz	50 Hz
Rated power consumption	420W	420W	450W
Outside dimensions	550*530*911 (mm)	530*550*909 (mm)	530*550*927 (mm)
Net weight	30 kg	30 kg	31 kg
Max water level (L)	59L	59L	64L
Tap water pressure	0.03-0.6 MPa	0.03-0.6 MPa	0.03-0.6 MPa
Washing noise	≤62 dB	≤62 dB	≤62 dB
Spin noise	≤72 dB	≤72 dB	≤72 dB



**REACH US AT**

Jaina India Pvt Limited, D-170, Okhla Industrial Area, Phase-I, New Delhi-110020

Customer Care: 1860 500 3555 | Website: [www.sansuiworld.com](http://www.sansuiworld.com)